

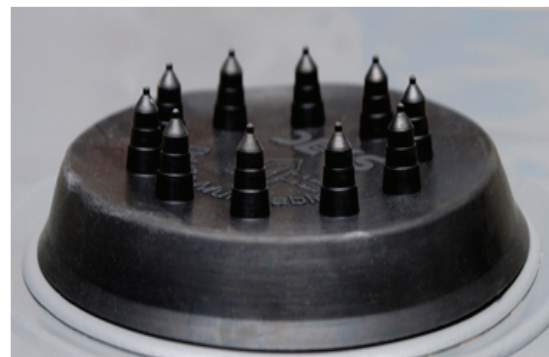

Installation Instructions

Fit the acrylic lead apron in the same way as a conventional lead weathering slate. The area where the tiles or slates have been cut or moved should be completely covered. It will normally be inserted under the tiles or slates above the penetration and dressed over the adjoining tiles or slates as shown below.



The cables should be passed through the flashing as follows:

- 1) Check exact outside diameter of the cables.
- 2) Cut the nipples as indicated for 4-6mm or 6-8mm cables. Use tin snips or scissors ensuring that the cut is straight and parallel to give a tight fit to the cable. **DO NOT** pierce the cable nipple with a craft knife or other pointed implement.

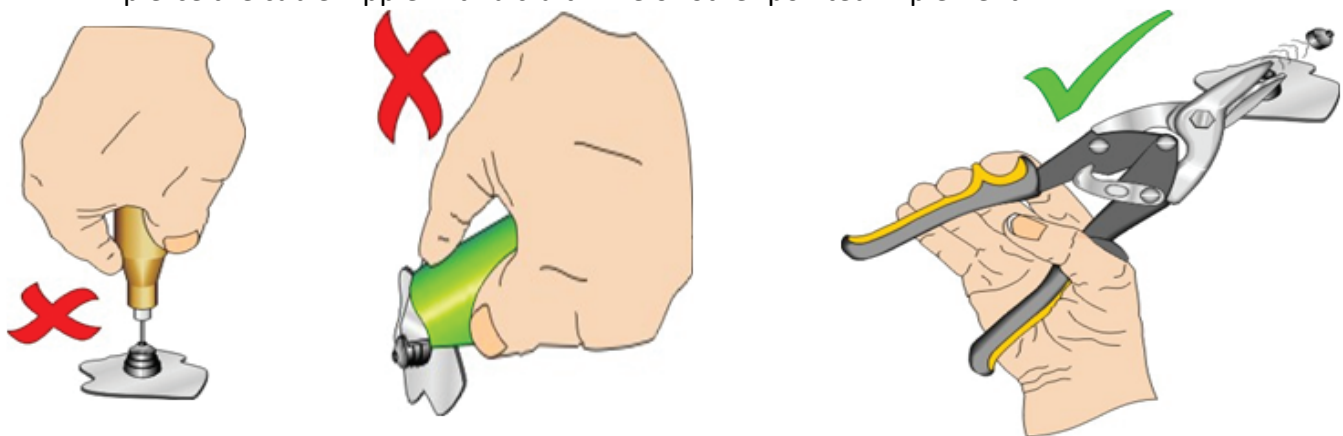

- 3) Pass cables through using water as a lubricant if needed.

Product code	Cable Diameter	Base size	Roof pitch	Material
DNLS10MB	4-8mm	490 x 410mm	0-45°	EPDM/lead base
SDA10MB	4-8mm	490 x 410mm	0-45°	EPDM/aluminium base